

Gloria 4 LCD Assembly

Materials

- LCD: 1x EastRising ERM2002FS-1-3.3V FSTN positive, white backlight
- Header: 1x Samtec MTLW-108-07-L-D-260 2x8 positions, 0.1" pitch, 0.260"L, TH
- Standoffs: 4x Essentra MDLSP2-02M-01 2mm

Header

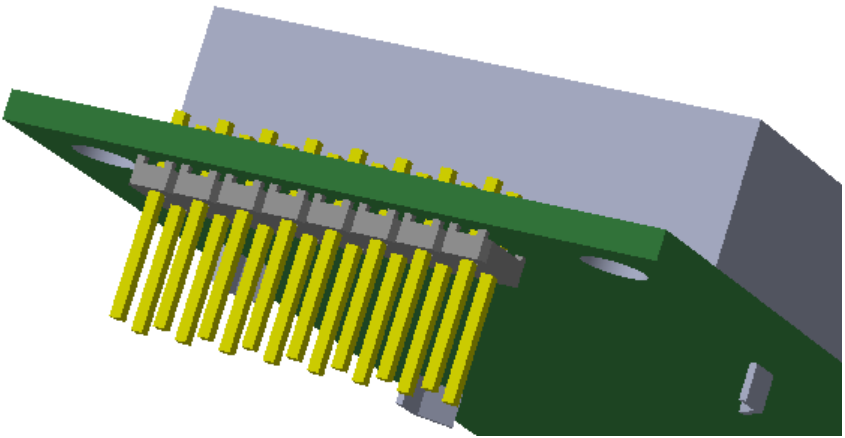

Solder the LCD header as shown, with the spacer flush to the underside of the LCD PCB. There is not much clearance at final assembly, so there can't be gaps between the spacer and the PCB.

Standoffs

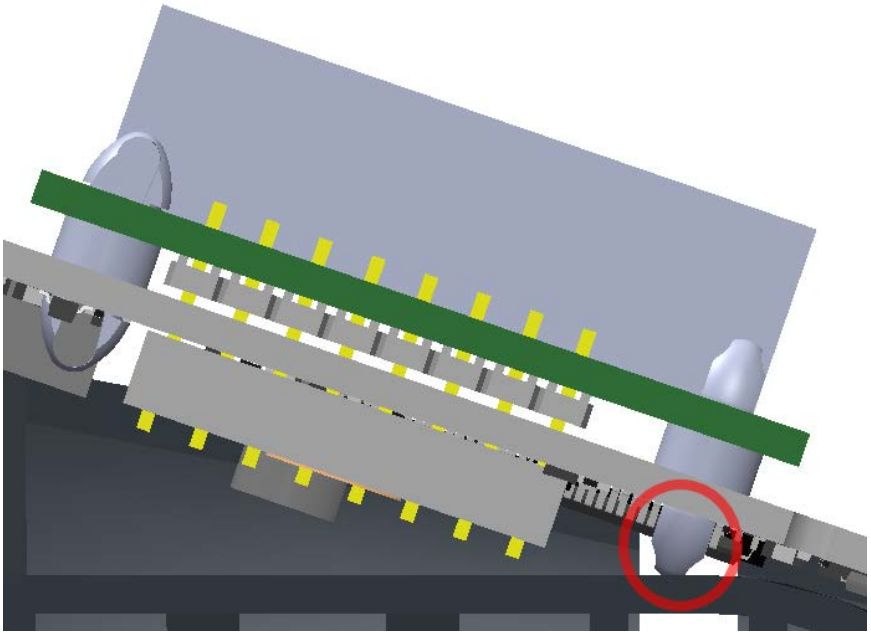

It's helpful to rotate the two lower LCD standoffs as shown, so the latch clip is horizontal. There is a slight interference with the top of the battery compartment on the bottom case, and if the standoffs are properly oriented it will make final assembly easier.

Final Assembly

Remove the LCD protective film before assembling the main PCB into the top case.